



CASH FR10 BACK PRESSURE VALVE REPAIR KIT INSTALLATION INSTRUCTIONS

Before installation, these instructions must be fully read and understood.

This kit is used to rebuild caterpillar P/N 235-3362, (Cash Valve P/N 22362. New smart number: FR1FFWSSFMEHCT-D)

FIGURE 1. 1-1/4" FR10 SECTION VIEW

REPAIR INSTRUCTIONS: (SEE FIGURE 1)

1. Measure distance from the top of the Adjustment Screw (item 1) to the top of the Locknut. Record this measurement for later use.
2. Turn Locknut counter-clockwise slightly to allow adjustment screw to turn.
3. Turn Adjustment Screw counter-clockwise and remove from the Spring Chamber.
4. Remove the Locknut from the Adjustment Screw. Discard the Adjustment Screw.
5. Place Locknut on the new Adjustment Screw supplied with the kit.
6. Remove the (8) Spring Chamber bolts and set aside for later use.
7. Remove the Spring Chamber, Spring Button, Spring, Diaphragm Sub-assembly (item 2), and Gasket (item 3) and discard items 2 and 3.
8. Position new Gasket from kit on the Valve.
9. Position new Diaphragm Sub-assembly from kit on top of the Gasket.
10. Re-assemble Spring, Spring Button and Spring Chamber. Tighten Spring Chamber bolts to 30 ft-lbs in a "crossing" or "star" pattern.
11. With the Locknut on the Adjustment Screw, thread Adjustment Screw into the Spring Chamber. Turn clockwise until the measurement from Step 1 is duplicated.
12. Tighten Locknut.

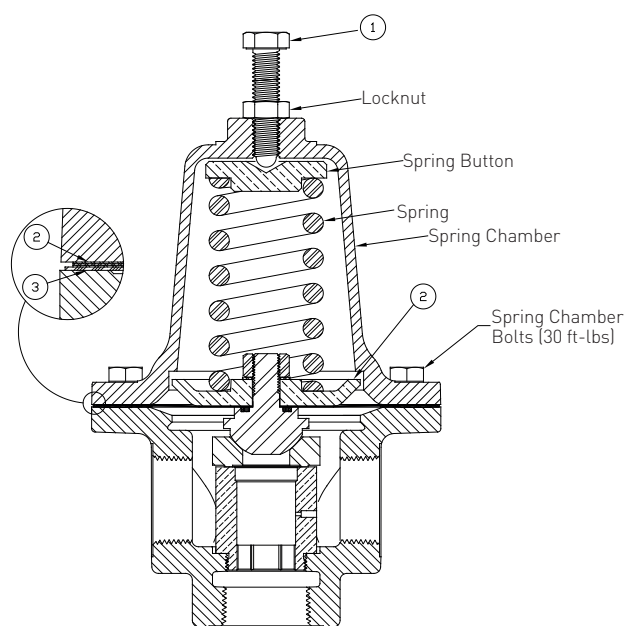

SUPPLIED COMPONENTS

Item No.	Quantity	Description
1	1	Adjustment Screw
2	1	Diaphragm Sub
3	1	Gasket

Repair is complete.

Neither Emerson, Emerson Automation Solutions, nor any of their affiliated entities assumes responsibility for the selection, use or maintenance of any product. Responsibility for proper selection, use, and maintenance of any product remains solely with the purchaser and end user.

Cash is a mark owned by one of the companies in the Emerson Automation Solutions business unit of Emerson Electric Co. Emerson Automation Solutions, Emerson and the Emerson logo are trademarks and service marks of Emerson Electric Co. All other marks are the property of their respective owners.

The contents of this publication are presented for informational purposes only, and while every effort has been made to ensure their accuracy, they are not to be construed as warranties or guarantees, express or implied, regarding the products or services described herein or their use or applicability. All sales are governed by our terms and conditions, which are available upon request. We reserve the right to modify or improve the designs or specifications of such products at any time without notice.